

1-10V LED Driver

Model: SR-2007-CC

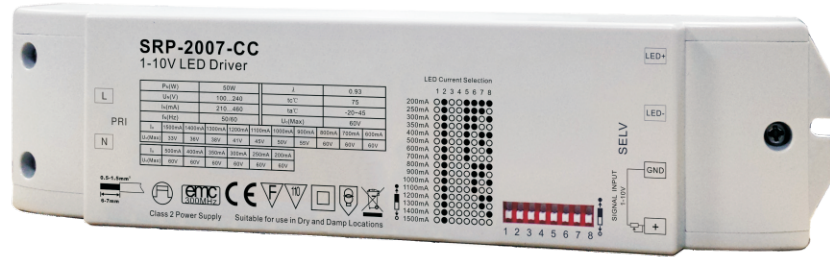

Parameter

$P_N(W)$	50W										λ	0.93
$U_N(V)$	100...240										$t_c(^{\circ}C)$	75
$I_N(mA)$	210...460										$t_a(^{\circ}C)$	-20~45
$f_N(Hz)$	50/60										$U_o(Max)$	60V
$I_o(CC)$	1500mA	1400mA	1300mA	1200mA	1100mA	1000mA	900mA	800mA	700mA	600mA		
$U_o(Max)$	33V	36V	38V	41V	45V	50V	55V	60V	60V	60V		
$I_o(CC)$	500mA	400mA	350mA	300mA	250mA	200mA						
$U_o(Max)$	60V	60V	60V	60V	60V	60V						

$I_o(CC)$ =output constant current
 $U_o(Max)$ = maximum output voltage

Product Size

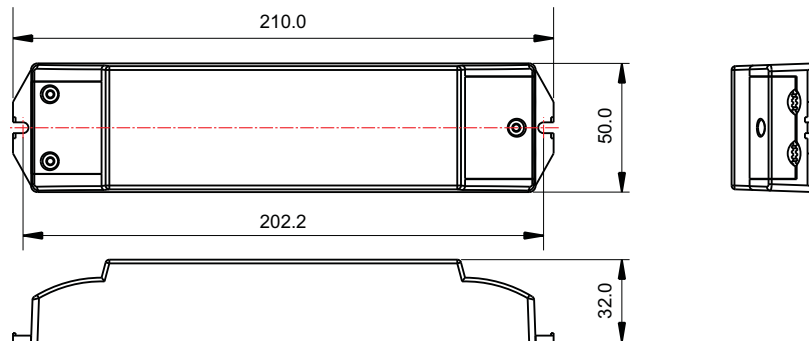

Wiring diagram

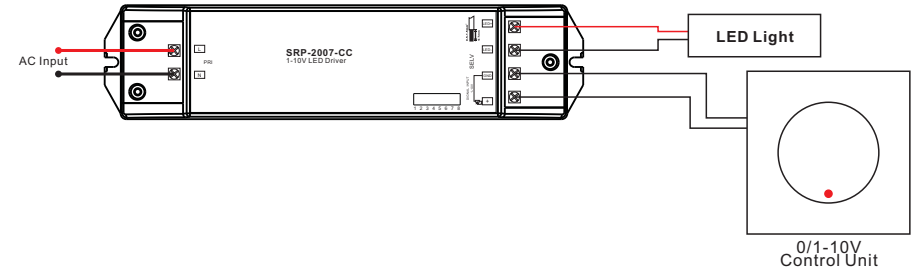

Feature

- Before connecting LED lights, please correctly setting the CC current via DIP switch
Please do not set the DIP switch with power
- With 1 Channel 1-10V signal Input, 1 Channel PWM Output
- 0-100% dimming range via logarithmic characteristic , perfect for human's vision
- 256 levels of Grey scales, smoothly without any flash
- Can coordinate with 1-10 regulator or 1-10V dimmer to do analog dimming ,smooth dimming curve, be in direct proportion to voltage curve of regular.

Safety & Warnings

- 1) The product shall be installed and serviced by a qualified person.
- 2) IP20.Please avoid the sun and rain. When installed outdoors, please ensure it is mounted in a water proof enclosure.
- 3) Always be sure to mount this unit in an area with proper ventilation to avoid overheating.
- 4) Please check if the output voltage of any LED power supplies used comply with the working voltage of the product.
- 5) Never connect any cables while power is on and always assure correct connections to avoid short circuits before switching on.
- 6) Please ensure that the cable is secured tightly in the connector
- 7) For update information please consult your supplier.

Warranty Agreement

- 1) We provide lifelong technical assistance with this product:
 - 5-year warranty. We print date on every products, for example :1125 means year 2011,week 25.The warranty is for free repair or replacement and covers manufacturing faults only.
 - For faults beyond the 3-year warranty we reserve the right to charge for time and parts.
- 2) Limited Warranty
 - Any defects caused by wrong operation.
 - Any damages caused by unauthorized removal, maintenance, modifying, incorrect connection and replacement of chips.
 - Any damages due to transportation, vibration etc. after purchase.
 - Any damages caused by earthquake, fire, lightning, pollution and abnormal voltage.
 - Any damages caused by negligence, inappropriate storing at high temperatures and humidity or near harmful chemicals.
 - Product has been updated
- 3) Repair or replacement as provided under this warranty is the exclusive remedy to the customer.